



**DEVELOPMENT VARIANCE PERMIT NO. DVP00285**

**TODD WHITTAKER AND MELISSA STULL**  
**Name of Owner(s) of Land (Permittee)**

**Civic Address: 1285 COLLEGE DRIVE**

1. This development variance permit is issued subject to compliance with all of the bylaws of the municipality applicable thereto, except as specifically varied by this permit.
2. This permit applies to and only to those lands within the municipality described below, and any and all building structures and other developments thereon:

Legal Description:

**LOT 3, SECTION 9, RANGE 8, MOUNTAIN DISTRICT, PLAN EPP24436**

**PID No. 029-055-741**

3. The City of Nanaimo "ZONING BYLAW 2011 NO. 4500" is hereby varied as follows:

*Section 7.4.1 - Lot and Size Dimensions*

Single Dwelling Residential (R1) lots are required to have a minimum lot depth of 30.0m. The applicant is requesting to vary the minimum lot requirement as follows (Schedule C):

- Lot B – to 29.13m, a variance of 0.87m.

4. The permittee, as a condition of the issuance of this permit, shall develop the land described herein strictly in accordance with the following terms and conditions and provisions and in accordance with any plans and specifications attached hereto which shall form a part thereof.

**Schedule A Location Plan**  
**Schedule B Proposed Subdivision**  
**Schedule C Site Plan**

5. If the permittee does not substantially commence the construction permitted by this permit within two years of the date of this permit, this permit shall lapse.
6. This permit prevails over the provisions of the bylaw in the event of conflict.
7. This permit is not a building permit nor does it constitute approval of any signage. Separate applications must be made for a building permit and sign permit.

AUTHORIZING RESOLUTION PASSED BY COUNCIL  
THE 16TH DAY OF MAY, 2016.

  
\_\_\_\_\_  
Corporate Officer

  
\_\_\_\_\_  
Date

Development Variance Permit DVP00285  
1285 College Drive

Schedule A

# Location Plan

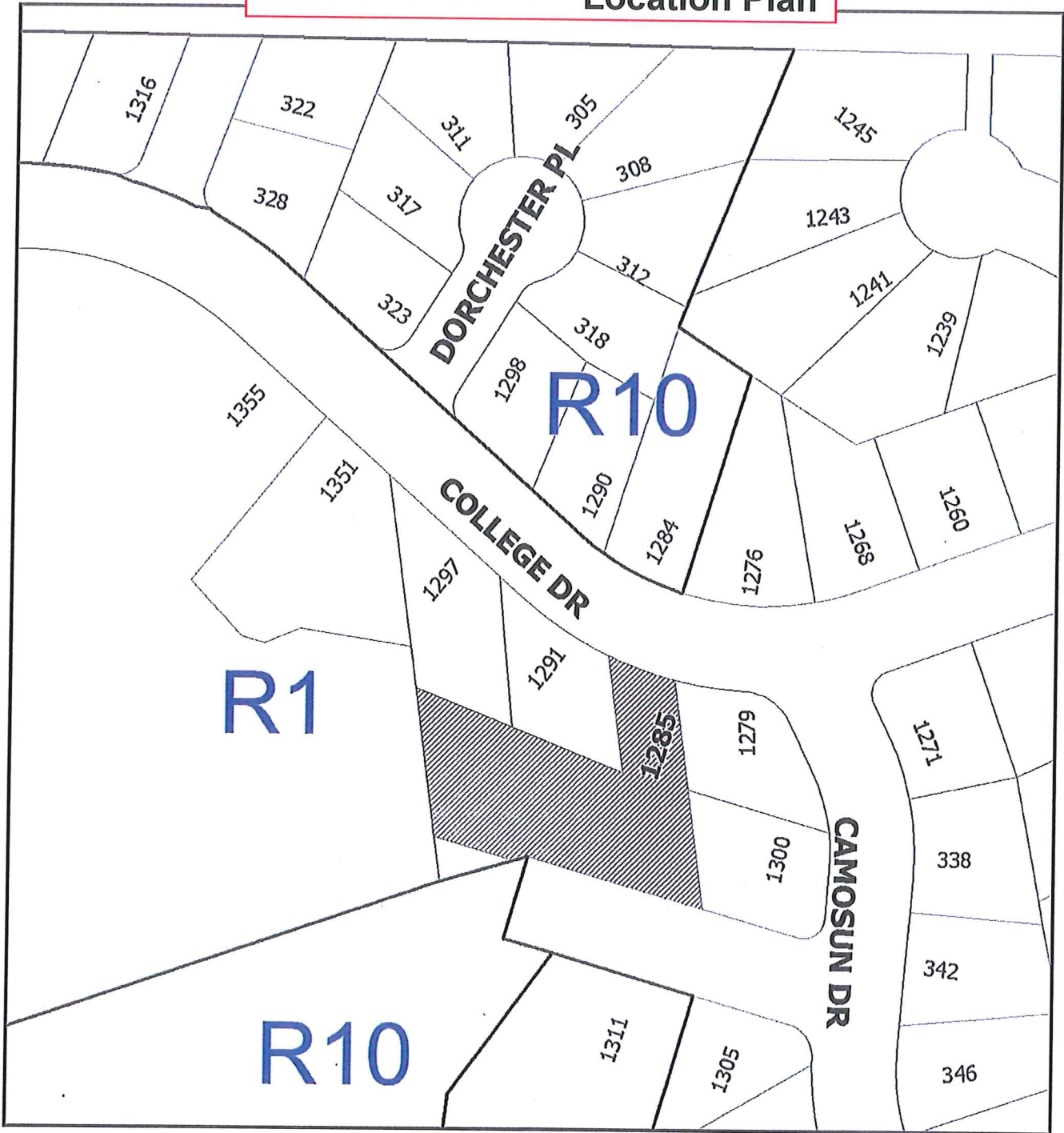

DEVELOPMENT VARIANCE PERMIT NO. DVP00285

## LOCATION PLAN

Civic: 1285 College Drive  
Lot 3, Section 9, Range 8, Mountain District,  
Plan EPP24436

 **Subject Property**



